



WWW.HYSTER.COM

**COUNTERBALANCED ELECTRIC
CUSHION TIRE
PRODUCT BROCHURE**

E80-120XN



BUILT FOR PEAK PERFORMANCE

Our electric E80-120XN series trucks meet the same high-performance standards as our counterbalanced ICE trucks in regard to acceleration, speed control and load-lift abilities. They also offer a low operating cost, along with zero emissions. Power-assisted braking means improved brake life and reduced operator braking effort.

Thermal management system

- The Hyster-designed thermal management system continuously monitors the controller and motor temperature. Upon identifying an irregularity, it protects the component by automatically adjusting truck performance.
- Large air inlet ports in the rear of the truck are protected and strategically positioned to provide fresh air intake for controller cooling.
- Heat sinks are used to draw heat away from the motor controllers, and cooling fans are positioned on top of the heat sink.

Durable components

- The Hyster-designed cast ductile iron steer axle provides maximum dependability. Its transverse, double-acting hydraulic cylinder, tapered roller spindle-support bearings and non-adjustable tie rods provide maximum durability with superior steering control and load handling.
- The unitized design and welded steel construction of the frame provide better rigidity and excellent protection for the internal components. The exceptional strength and durability of the frame are designed and tested using computer-generated finite element analysis. A stamped steel hood provides a durable, long-lasting exterior.
- The full floating design of the drive axle lets the axle housing, not the shafts, carry the weight of the load.
- Wet disc brakes provide excellent stopping power with low brake pedal effort, while also requiring no adjustments and minimal servicing (periodic lubrication changes at 4,000-hr intervals).



Heat sink

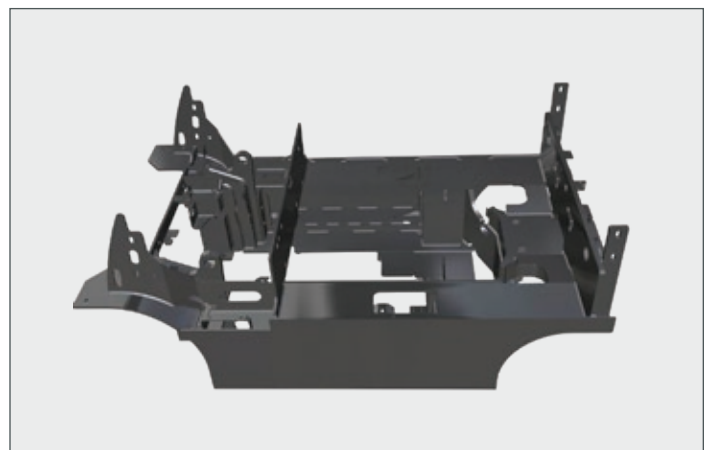

Frame



Industrial-strength electronics

- CANbus communications network reduces wiring complexity, providing superior dependability.
- Double-sealed electrical connectors provide a waterproof connection to prevent contamination.
- A smart, one-way routing path for wire harnesses helps to make high-quality assembly consistent while increasing durability and simplifying maintenance when needed.
- Non-mechanical, hall-effect sensors and switches are designed to outlast the life of the truck.
- The Pacesetter Vehicle System Manager (VSM) industrial on-board computer manages truck operations to help maximize uptime.

Hassle-free hydraulics

- Leak-free O-ring face seal fittings help reduce leaks for enhanced reliability.
- A 10-micron, high-performance, in-tank filtration system captures 99.5 percent of hydraulic system debris, significantly extending component life.
- Smart placement of the control valve and hydraulic lines away from heat sources reduces operating temperature, extending the life of seals and hoses and improving longevity.

LOW COST OF OWNERSHIP

The Hyster® E80-120XN series can lower your cost of operations by delivering increased productivity, lowered energy consumption, advanced dependability and reduced maintenance costs. The standard AC traction and hydraulic motors are unsurpassed in the materials handling industry so they spend more time working and less time being worked on.



Brushless AC technology

- The E80-120XN is a full AC product, utilizing AC traction and hydraulic motors eliminating the motor brushes and the commutator, as well as related parts and service costs.
- A single hydraulic pump and motor is utilized for both the mast and steering functions decreasing the number of components and reducing the chances of failure.

Vehicle System Manager

- The Pacesetter VSM monitors and communicates the truck's multiple systems via the CANbus communication system, keeping a constant check on the unit and vital components.
- All vehicle systems are managed electronically to optimize performance and significantly increase overall reliability and enhance diagnostic capabilities for maximum uptime.
- The VSM enables customization of truck performance to suit application needs.

Superior serviceability

- The E80-120XN series utilizes CANbus communications to simplify wiring and improve serviceability.
- State-of-the-art on-board diagnostics reduce repair time and minimize expensive parts swapping.
- A two-piece floor plate and side plates can be easily removed for unrestricted service access. The lift-out floor plates require no tools, for quick and easy daily operator checks.
- Easy battery access is provided via the spring-assisted hood and quick release handle. The rear counterweight service cover is easily removed by removing two screws.

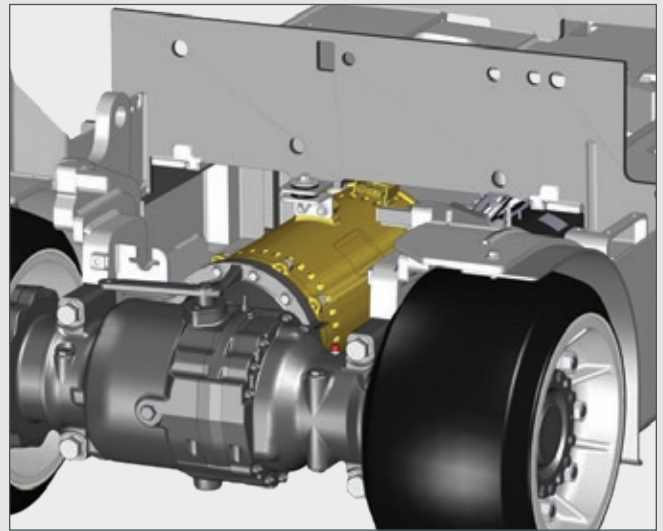

AC traction motor



A spring-assisted hood and quick release handle make battery access easier than ever.

ERGONOMICS

The superior ergonomic design of the E80-120XN means greater comfort for your operator. Enhanced ergonomics combined with customizable performance characteristics increase overall productivity and uptime.

Operator compartment

- The operator convenience station features an industry-leading dash storage area that provides the operator with a productive work environment and dedicated storage areas for markers, cell phone, pick tickets, beverages and almost anything else an operator needs.
- The easy-to-use 3-point entry design of the operator compartment uses a large molded hand grip, hip restraint and an open non-slip lowered step height to help minimize muscle and joint strain during entry and exit.
- High-comfort seat conforms to the operator to reduce operator fatigue. With no-cinch ELR seat belts and 6 inches of fore/aft adjustment with 13 latching positions. The optional full suspension seat features an adjustable seat back and weight adjustment control. The optional swivel seat provides 6 degrees left swivel and 12 degrees right swivel.



High-comfort seat



3-point entry design



Operator convenience station

Low-effort operation

- The automatic park brake option automatically applies the parking brake when the truck is stationary and releases it when the accelerator pedal is depressed. Power-assisted braking improves brake life while reducing operator effort.
- The standard 12-inch steering wheel with integrated spinner knob reduces fatigue while providing more knee room and offers superior efficiency, maneuverability and control.
- An infinitely adjustable tilt steer column provides increased comfort while minimizing fatigue. The optional telescopic steer column with tilt memory provides enhanced adjustability to accommodate the full operator size range.
- Improved brake pedal layout allows actuation with either foot and the Auto Deceleration System significantly reduces operator fatigue.
- Rear drive handle (optional) is excellent for reverse driving while giving ready access to the auxiliary horn button for use when approaching cross-aisles and pedestrian traffic areas.

Hydraulic controls

- Choose from two configurations that employ seat side hydraulic levers or TouchPoint mini-levers to provide unsurpassed, low effort, tactile control of all hydraulic functions.
- Optional electro-hydraulic controls with TouchPoint mini-levers provide precise fingertip control of all hydraulic functions. An adjustable armrest with palm rest, mounted on the operator seat, positions the mini-levers in the optimal position.
- The armrest is cushioned and contoured to provide full forearm support. The hydraulic functions, seat side directional control switch, horn and battery disconnect button are all incorporated in the armrest and designed to maximize operator comfort and ease of use.



Electro-hydraulic controls with TouchPoint mini-levers

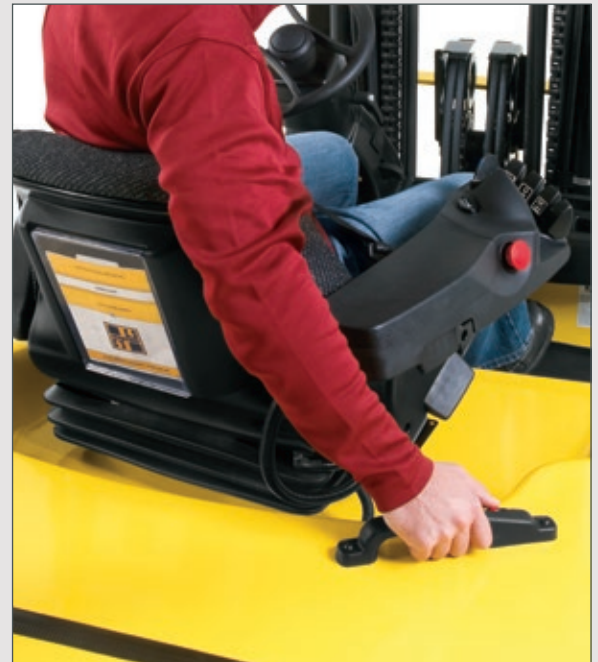

Rear drive handle

PRODUCTIVITY

The Hyster® E80-120XN works harder, longer and faster without compromising safety to make it one of the most productive lift trucks in the industry. The end result is a lift truck that increases throughput and sales volume while reducing operating costs.



Superior operator control

- Mast provides fast lift and lower speeds combined with superb visibility.
- The optional Hyster-designed integral sideshift provides excellent visibility and affords greater capacities than carriage mounted sideshifts.
- Low-effort ergonomics and intuitively-located controls provide superior operator comfort.
- The seat side directional control and the Hyster exclusive MONOTROL® pedal each provide for quicker, smoother control of travel speed and direction, improving operator efficiency and bolstering productivity.
- On-demand hydrostatic steering provides low-effort steering and superior control with reduced noise.
- The multifunction display features a large LCD backlit screen that shows truck status for quick and easy diagnostics.

Performance modes

- An adjustment of customizable performance parameters to match your application needs is accessible via the multifunction display and technician password protection.
- A significant increase in loaded travel speeds and acceleration rates beyond the standard setting is possible when the “extended shift” setting is turned off.
- Our standard “extended shift” AC controller setting provides the optimum balance between performance needs and battery shift life.

AC technology

- AC technology delivers quick and smooth changes in travel direction and offers precise speed control with excellent acceleration thereby significantly increasing productivity potential.
- The standard “extended shift” feature allows enhanced run time without recharging over longer periods.
- The Hyster-designed thermal management system maximizes performance during continuous operation, while preventing damage to components due to heat.



MONOTROL® pedal



Seat side directional control



Multifunction display

PERFORMANCE

Hyster Stability System (HSS®)

Hyster® E80-120XN series trucks are built for superior stability, so operators can trust them with tall loads, long loads and all loads in-between. Our patented system is built into the fundamental design of every truck to allow for articulation on uneven surfaces and to minimize truck lean for enhanced lateral stability.

- Hyster Stability System is a 100% maintenance-free design.
- Its “passive” mechanical system uses gravity to optimize steer-axle geometry.
- Trunnion-mounted masts increase long load center handling.
- Mast channels built with one-piece, high-strength rolled steel.
- Load rollers are canted at 3 degrees to resist forward/backward movement.

Superior trucks. Superior options.

- Application environmental construction
 - Standard construction
 - Operating temperatures: +32° F to +120° F
 - Cooler/freezer package option
 - Operating temperatures: -20° F to +120° F
- Return to set tilt option brings the load to a preset position when tilting for easy operation.
- Operator selectable performance modes allow varying levels of truck performance.
- Rapid charge option further improves productivity by eliminating battery changes.
- 36-, 48- or 80-volt systems provide excellent performance.
- 80-volt control system option for maximum performance in long-haul applications.
- Extended shift can be disabled for increased productivity levels.







Hyster Company
P.O. Box 7006, Greenville, North Carolina 27835-7006

© Hyster Company. 2023, all rights reserved. Hyster and  are trademarks of Hyster-Yale Group, Inc. Hyster products are subject to change without notice. Trucks may be shown with optional equipment.

CERTIFICATION: Hyster lift trucks meet the design and construction requirements of B56.1-1969, per OSHA Section 1910.178(a)(2), and also comply with the B56.1 revision in effect at time of manufacture. Certification of compliance with the applicable ANSI standards appears on the lift truck. Performance specifications/ratings are for truck equipped as described under standard equipment in this technical guide. Performance specifications are affected by the condition of the vehicle and how it is equipped, as well as by the nature and condition of the operating area. Specifications are subject to change and the proposed application should be discussed with your authorized Hyster Company dealer.