



WWW.HYSTER.COM

LITHIUM-ION POWERED PALLET TRUCK
PRODUCT BROCHURE

PCS30UT



PCS30UT OVERVIEW

The Hyster® lithium-ion powered pallet truck PCS30UT offers helps to improve efficiency by reducing operator effort and assists in lowering the total cost of ownership through lower maintenance requirements. Similar to a hand pallet truck, it is compact and lightweight with minimal maintenance requirements. The PCS30UT can be operated with very little downtime, due to a 6-second battery exchange time.

- Compact, lightweight design
- Powered travelling, lifting and lowering
- Up to 3 times more efficient than a hand pallet truck
- 6-second battery exchange
- Recharge alert
- Intelligent remote control key option
- Optional large battery with 3-hour fast charger
- Emergency reverse button
- Ergonomic, multi-function handle with LCD display to maximize uptime
- Simple to maintain
- Maintenance-free components, including brushless drive motor and lithium-ion battery
- 60-second drive wheel replacement
- Durable steel frame and protective cover
- Performs well on gradients

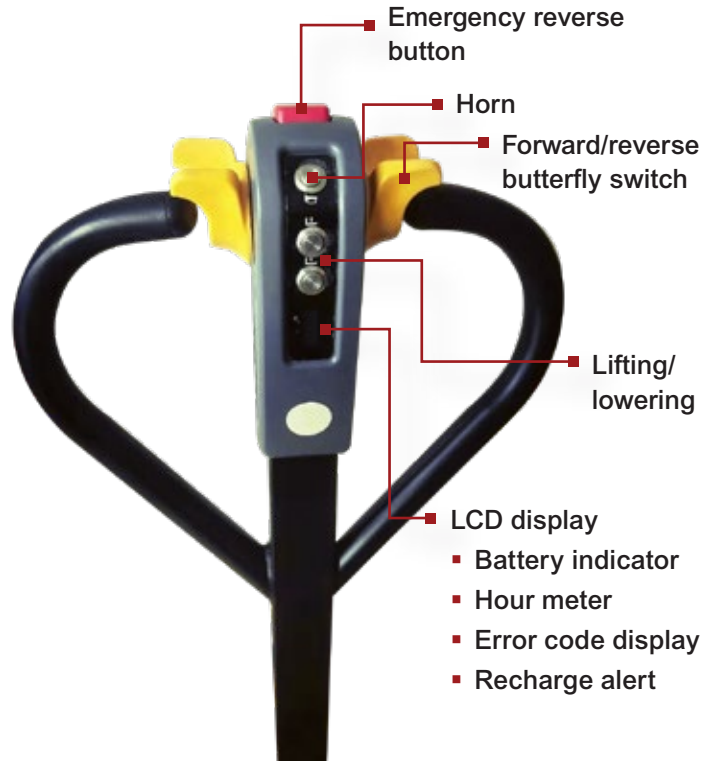

POWERED PALLET TRUCK VS. HAND PALLET TRUCK

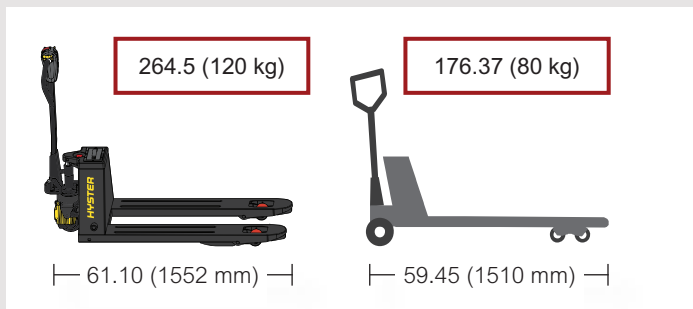

Compact and lightweight



Single/dual tandem load wheels

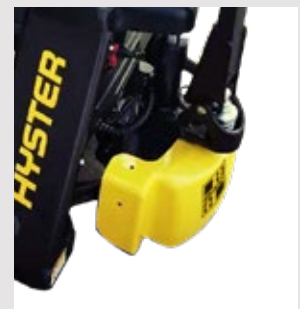

Protective cover

SPECIFICATIONS AND DIMENSIONS

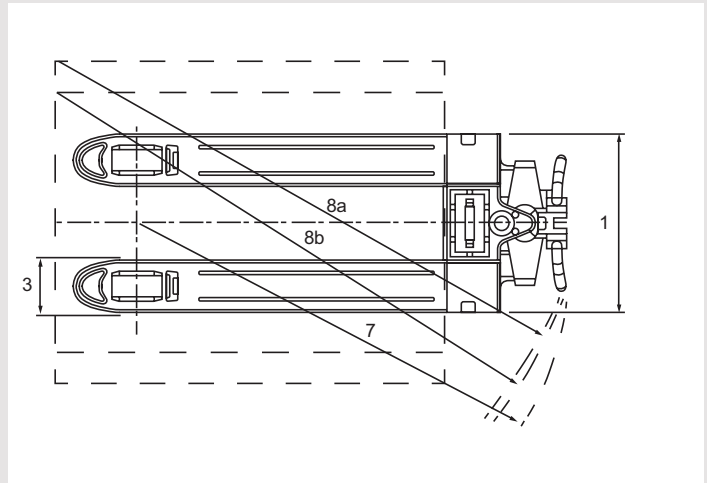
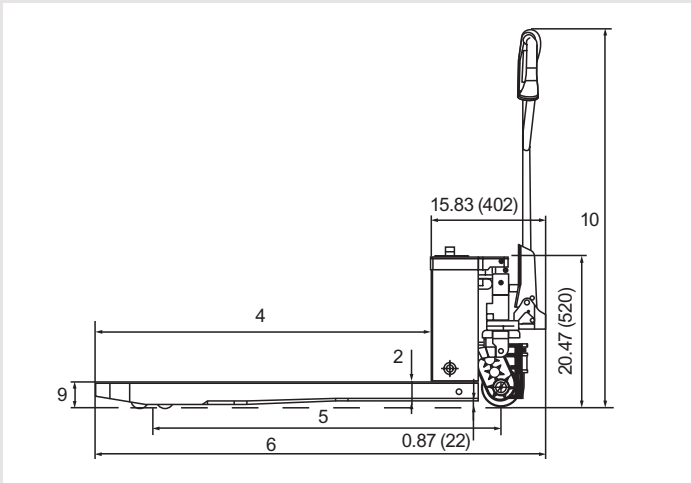

MANUFACTURER	MEASUREMENT	HYSTER
Model designation		PCS30UT
Operator type		Pedestrian
Rated capacity	lb (kg)	3300 (1500)
Load center	in (mm)	23.6 (600)
Overall fork width	[1] in (mm)	21.65 (550)/26.97(685)
Fork dimensions	[2/3/4] in (mm)	2.28 (58) x 6.30 (160) x 45.28 (1150)/2.28 (58) x 6.30 (160) x 48 (1220)
Wheelbase	[5] in (mm)	47.12 (1197)/49.88 (1267)
Overall length	[6] in (mm)	61.10 (1552)/(63.86) 1622
Turning radius (raised)	[7] in (mm)	53.26 (1353)/56.14 (1426)
Right angle stack (39.37 x 47.24 crossway/31.50 x 47.24 lengthways)	[8a/8b] in (mm)	α 67.64 (1718)/ β 66.41 (1687)
Lowered height - top of forks	[9] in (mm)	3.23 (82)
Total lift	in (mm)	4.52 (115)
Height of tiller (min./max.)	[10] in (mm)	32.28 (820)/45.28 (1150)
Maximum gradeability (loaded/unloaded)	%	6/20
Travel speed (loaded/unloaded)	mph (km/h)	2.5 (4.0)/2.80 (4.5)
Control type		DC
Drive/lift motor	kw	0.75/0.5
Lift speed - loaded/unloaded (lowering speed - loaded/unloaded)	ft/min	3.54/4.53 (11/9)
Travel brake type		Regenerative
Service brake type		Electromagnetic
Service weight (includes battery)	lb (kg)	264.55 (120)/275.58 (125)
Axle loading-laden front/ ear/unladen front/rear	lb (kg)	2,500 (1134)/1,071.4 (486)/194 (88)/70.5 (32)
Drive wheel x(1)	in (mm)	\varnothing 5.51 (140) x 2.16 (55) Poly (1)
Load wheel (single x2/dual x4)	in (mm)	\varnothing 3.15 (80) x 3.66 (93) Poly/ \varnothing 3.14 (80) x 2.75 (70) poly
Battery type		Lithium
Battery capacity	Ah	10/15
Battery voltage	V	48
Power consumption in accordance with VDI cycle	kWh/h	0.42
Sound level at driver's ear EN12053	dB(A)	69

OPERATOR ASSIST FEATURES

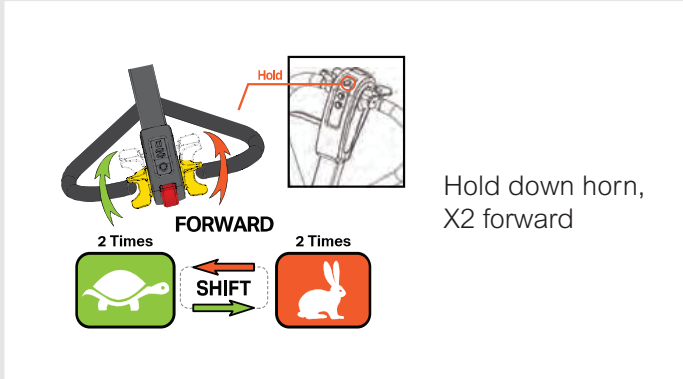

Speed setting

Convenient fast/slow pre-set speeds

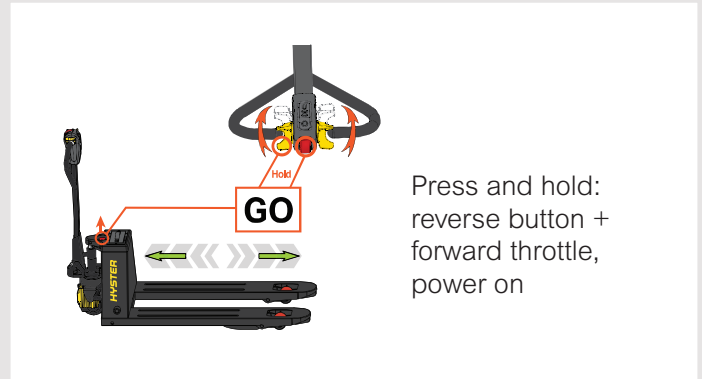

Up-right drive

Maximize efficiency in tight spaces

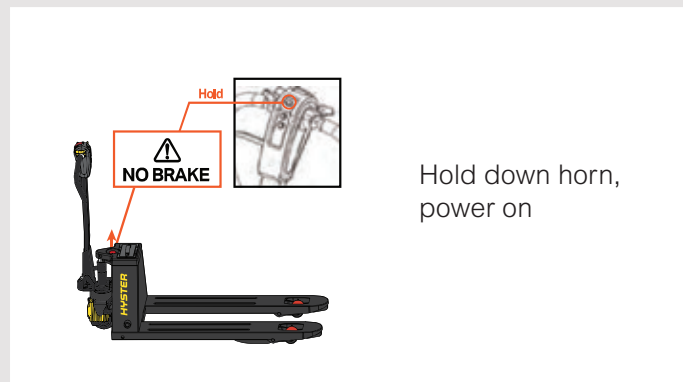

Service mode

Utilize brake release in emergencies



Hyster Company
P.O. Box 7006, Greenville, North Carolina 27835-7006

© Hyster Company. 2023, all rights reserved. Hyster and  are trademarks of Hyster-Yale Group, Inc.

Hyster products are subject to change without notice. Trucks may be shown with optional equipment.