

WWW.HYSTER.COM

LITHIUM-ION POWERED PALLET TRUCK

PRODUCT BROCHURE

PCS 1.5UT



PSC1.5UT OVERVIEW

The Hyster® lithium-ion powered pallet truck PSC1.5UT offers helps to improve efficiency by reducing operator effort and assists in lowering the total cost of ownership through lower maintenance requirements. Similar to a hand pallet truck, it is compact and lightweight with minimal maintenance requirements. The PSC1.5UT can be operated with very little downtime, due to a 6-second battery exchange time.

- Compact, lightweight design
- Powered travelling, lifting and lowering
- Up to 3 times more efficient than a hand pallet truck
- 6-second battery exchange
- Recharge alert
- Intelligent remote control key option
- Optional large battery with 3-hour fast charger
- Emergency reverse button
- Ergonomic, multi-function handle with LCD display to maximize uptime
- Simple to maintain
- Maintenance-free components, including brushless drive motor and lithium-ion battery
- 60-second drive wheel replacement
- Durable steel frame and protective cover
- Performs well on gradients
- 59" (1500mm) load backrest +
- Retractable cargo belt +

+ = Optional equipment

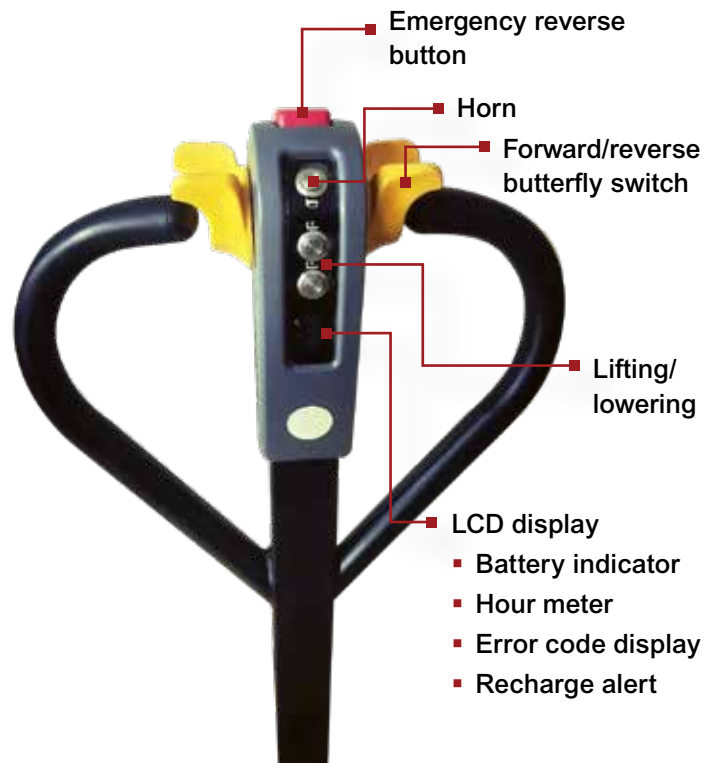

POWERED PALLET TRUCK VS. HAND PALLET TRUCK

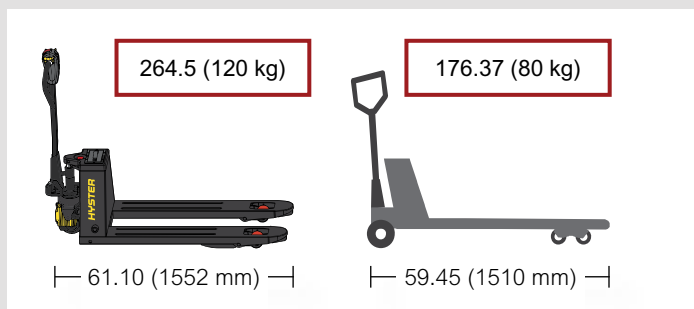

Compact and lightweight



Single/dual tandem load wheels

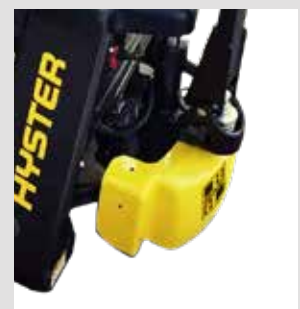

Protective cover

SPECIFICATIONS AND DIMENSIONS

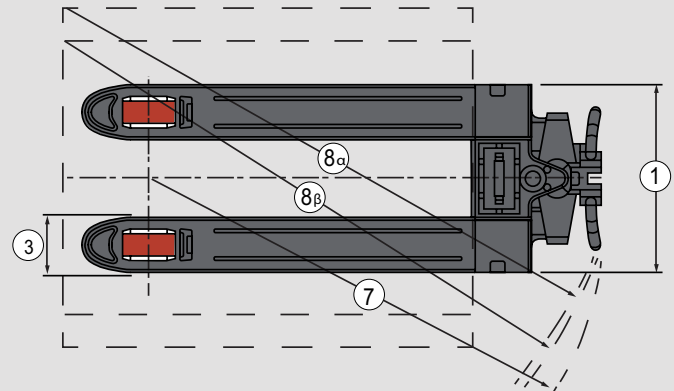
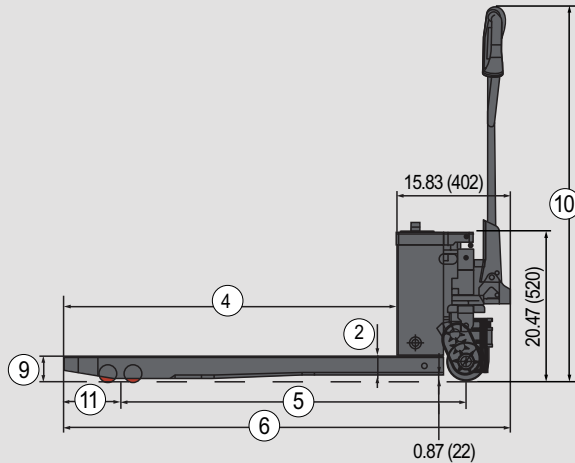

MANUFACTURER	MEASUREMENT	HYSTER
Model designation		PCS1.5UT
Operator type		Pedestrian
Rated capacity	lb (kg)	3300 (1500)
Load center	in (mm)	23.6 (600)
Overall fork width	[1] in (mm)	21.65 (550)/26.97(685)
Fork dimensions	[2/3/4] in (mm)	2.28 (58) x 6.30 (160) x 45.28 (1150)/2.28 (58) x 6.30 (160) x 48 (1220)
Wheelbase	[5] in (mm)	47.12 (1197)/49.88 (1267)
Overall length	[6] in (mm)	61.10 (1552)/(63.86) 1622
Turning radius (raised)	[7] in (mm)	53.26 (1353)/56.14 (1426)
Right angle stack (39.37 x 47.24 crossway/31.50 x 47.24 lengthways)	[8a/8b] in (mm)	α 67.64 (1718)/ β 66.41 (1687)
Lowered height - top of forks	[9] in (mm)	3.23 (82)
Total lift	in (mm)	4.52 (115)
Height of tiller (min./max.)	[10] in (mm)	32.28 (820)/45.28 (1150)
Maximum gradeability (loaded/unloaded)	%	6/20
Travel speed (loaded/unloaded)	mph (km/h)	2.5 (4.0)/2.80 (4.5)
Control type		DC
Drive/lift motor	kw	0.75/0.5
Lift speed - loaded/unloaded (lowering speed - loaded/unloaded)	ft/min	3.54/4.53 (11/9)
Travel brake type		Regenerative
Service brake type		Electromagnetic
Service weight (includes battery)	lb (kg)	264.55 (120)/275.58 (125)
Axle loading-laden front/ ear/unladen front/rear	lb (kg)	2,500 (1134)/1,071.4 (486)/194 (88)/70.5 (32)
Drive wheel x(1)	in (mm)	Ø5.51 (140) x 2.16 (55) Poly (1)
Load wheel (single x2/dual x4)	in (mm)	Ø3.15 (80) x 3.66 (93) Poly/Ø3.14 (80) x 2.75 (70) poly
Load wheel center to fork tip (raised/lowered)	[11] in (mm)	10.71 (272)/ 7.80 (198)
Battery type		Lithium
Battery capacity	Ah	10/15
Battery voltage	V	48
Power consumption in accordance with VDI cycle	kWh/h	0.42
Sound level at driver's ear EN12053	dB(A)	69

OPERATOR ASSIST FEATURES

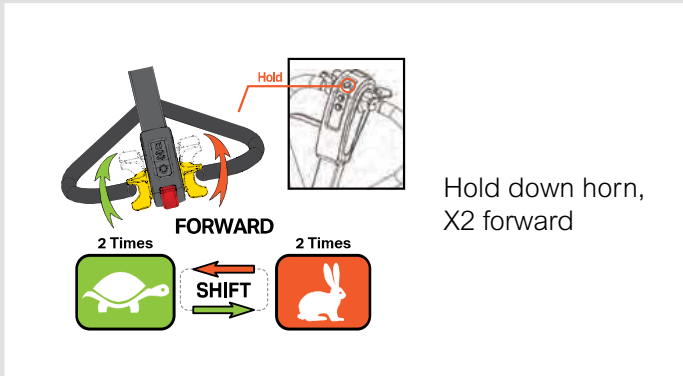

Hold down horn,
X2 forward

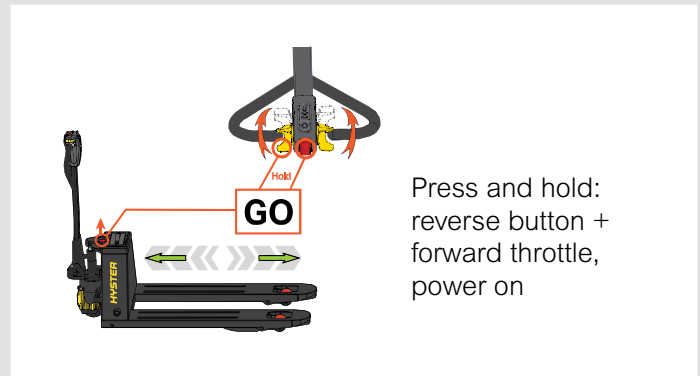

Press and hold:
reverse button +
forward throttle,
power on

Speed setting

Convenient fast/slow pre-set speeds

Up-right drive

Maximize efficiency in tight spaces

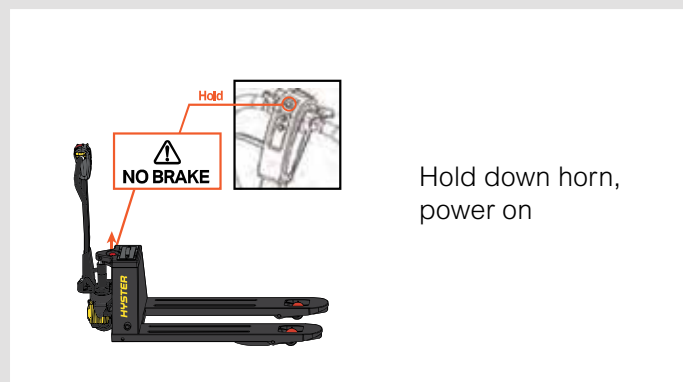

Hold down horn,
power on

Service mode

Utilize brake release in emergencies



Hyster Company
P.O. Box 7006, Greenville, North Carolina 27835-7006

© 2025 Hyster-Yale Materials Handling, Inc., all rights reserved. Hyster and  are trademarks of Hyster-Yale Materials Handling, Inc. Hyster products are subject to change with notice. Trucks may be shown with optional equipment and/or features not available in all regions.